

**CATALOG.54**

# **Sewer Cable**

## ***Equipment Company***

**TO ORDER CALL TOLL-FREE**  
**800.772.7026**

**SEWER •  
& DRAIN  
CLEANING  
MACHINES**

**CABLES •**

**CUTTERS •**

**REPAIRS •**

**PARTS •**

**RIDGID®**  
**Kollmann**

***General***  
***PIPE CLEANERS***



**GORLITZ**  
**SEWER & DRAIN INC.**



**AUTHORIZED  
RIDGID-KOLLMAN  
"SEE SNAKE"  
REPAIR CENTER**



**CREDIT CARDS ACCEPTED**

\* PRODUCTS & EQUIPMENT CONTAINED WITHIN THIS CATALOG MAY VARY.  
PLEASE CHECK WITH SEWER CABLE EQUIPMENT CO. REGARDING AVAILABILITY.

# WHERE WE'RE LOCATED...

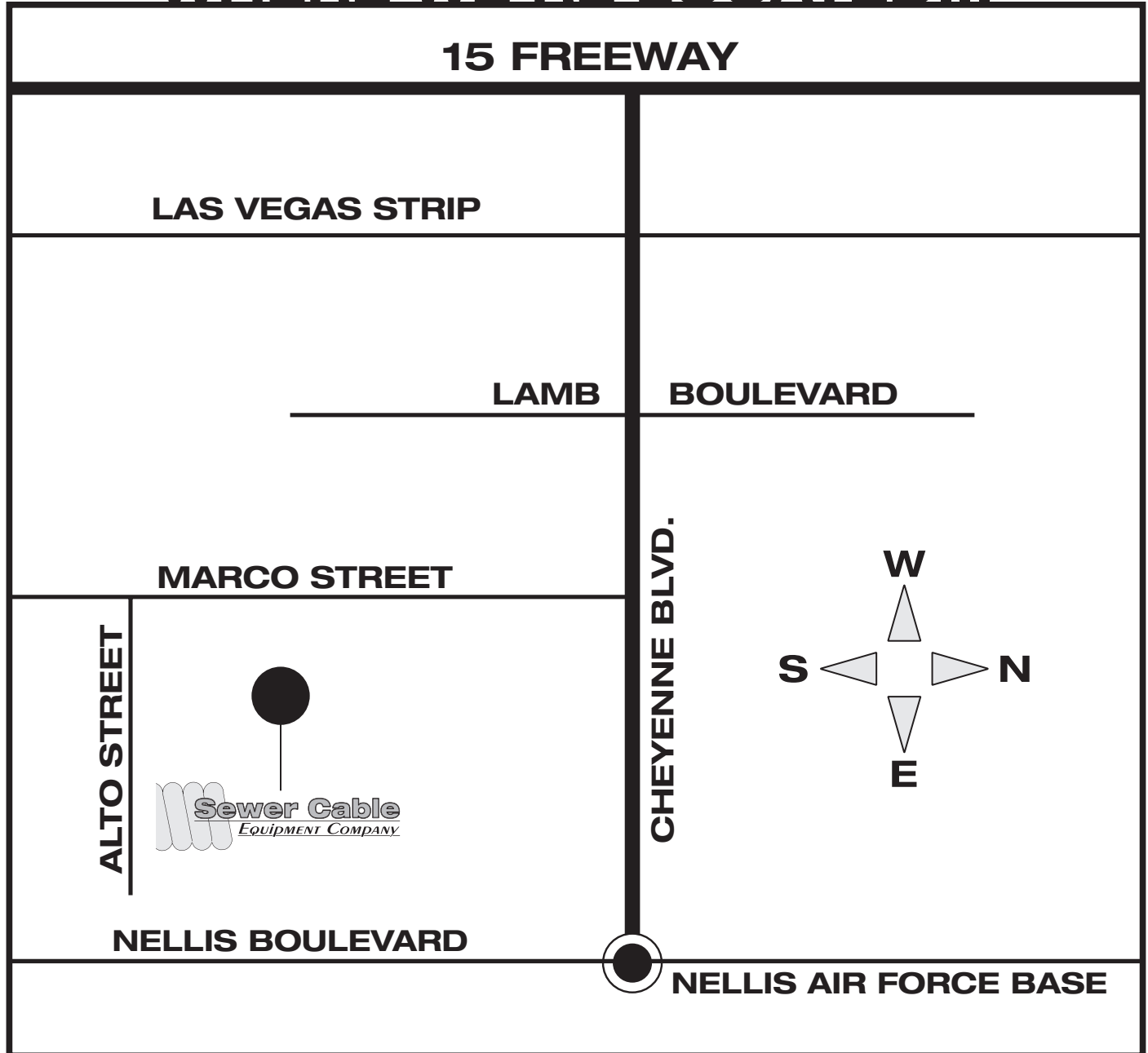

## SEWER CABLE EQUIPMENT COMPANY

2834 MARCO STREET

LAS VEGAS • NEVADA, 89115

702.433.5401 • FAX 702.433.5403

**TOLL-FREE 800.772.7026**

Email: [sewcab@gmail.com](mailto:sewcab@gmail.com)

[www.SewerCableEquip.com](http://www.SewerCableEquip.com)



## **Sewer Cable**

*Equipment Company*

**REPAIRS & SERVICES ALL MAKES  
OF DRAIN CLEANING EQUIPMENT INCLUDING:**

- **BURTON PATTERN**
- **GENERAL**
- **GORLITZ**
- **ELECTRIC EEL**
- **RIDGID KOLLMANN**
- **SPARTAN**
- **FLEXIBLE**



## **Sewer Cable**

*Equipment Company*

**IS AN AUTHORIZED SERVICE &  
REPAIR CENTER FOR RIDGID KOLLMANN SEE  
SNAKE PIPE INSPECTION, LOCATING & LEAK  
DETECTION EQUIPMENT. ALSO COMPLETE  
SERVICE & MAINTENANCE ON ALL MAKES OF  
JETTER EQUIPMENT.**



## **Sewer Cable**

*Equipment Company*

**BUYS, SELLS & TRADES ALL DRAIN  
CLEANING EQUIPMENT.**

## **SEWER CABLE EQUIPMENT COMPANY**

**2834 MARCO STREET**

**LAS VEGAS • NEVADA, 89115**

**702.433.5401 • FAX 702.433.5403**

**TOLL-FREE 800.772.7026**

**Email: [sewcab@gmail.com](mailto:sewcab@gmail.com)**

**[www.SewerCableEquip.com](http://www.SewerCableEquip.com)**

**ON YOUR NEXT VISIT TO LAS VEGAS, VISIT OUR SHOWROOM.  
"NO COVER, NO MINIMUM CHARGE REQUIRED"**



## **BURTON PATTERN POWER SNAKE**

**1**

MODEL 62 POWER SNAKES  
PARTS ILLUSTRATIONS  
1/2", 5/8", 3/4" CABLES  
SUR LOK CUTTERS (ACCESSORIES)  
SUR LOK COUPLERS & ADAPTERS  
3/8" CABLES & PARTS  
5/16" CABLE & PARTS  
SUR LOK REPAIR INSTRUCTIONS  
WARRANTY & INFORMATION

PAGE 5  
PAGE 6  
PAGE 7  
PAGE 8 - 9  
PAGE 10  
PAGE 11  
PAGE 12  
PAGE 13  
PAGE 14



## **RIDGE TOOL COMPANY**

**PLEASE  
CALL**

PLEASE CALL OR EMAIL FOR CURRENT INFORMATION & PRICING!



## **GENERAL WIRE SPRING CO.**

**PLEASE  
CALL**

PLEASE CALL OR EMAIL FOR CURRENT INFORMATION & PRICING!



## **GORLITZ SEWER & DRAIN INC.**

**PLEASE  
CALL**

PLEASE CALL OR EMAIL FOR CURRENT INFORMATION & PRICING!



## **SHU-BEE CUSTOMER CARE WEAR**

**PLEASE  
CALL**

PLEASE CALL OR EMAIL FOR CURRENT INFORMATION & PRICING!

# BURTON PATTERN POWER SNAKE • SECTION 1

**POWERSNAKES • CABLES, CUTTERS, COUPLERS, & ADAPTERS  
REPAIR PARTS & INSTRUCTIONS • ACCESSORIES**



## MODEL 62 POWER SNAKES

PART NO.	CABLE LENGTHS	WEIGHT
12.075.62	(1) 1/2" X 75'	115 LBS.
12.100.62	(1) 1/2" X 100'	122 LBS.
34.075.62	(1) 3/4" X 75'	155 LBS.
34.100.62	(1) 3/4" X 100'	176 LBS.
34.200.62	(2) 3/4" X 100' - 1200'	291 LBS.
34.200.62HD *	(2) 3/4" X 100' - 1200'	284 LBS.
AB.075.62	(1) 1/2" X 75'; (1) 3/4" X 75'	211 LBS.
AB.751.62	(1) 1/2" X 75'; (1) 3/4" X 100'	232 LBS.
AB.752.62	(1) 1/2" X 75'; (2) 3/4" X 100' - 1200'	347 LBS.
AB.752.62HD *	(1) 1/2" X 75'; (2) 3/4" X 100' - 1200'	339 LBS.

\* EXTRA HEAVY DUTY MOTOR OPERATES UP TO 400' OF 3/4" CABLE. AVAILABLE ON ALL MODEL 62'S FOR AN ADDITIONAL CHARGE.

Models 62-A/B are **LIGHTWEIGHT AND COMPACT** FOR EASY PORTABILITY and are designed for cleaning Drain and Sewer Lines. Model 62-A (1/2" Cable) for clearing 1 1/4" to 3" Drain Line stoppages of grease, scale, and sludge. Model 62-B (3/4" Cable) for 3"-4"-6"-8" Sewer Lines will cut, saw, and chew through heavy tree roots with power to spare. Cable rotation is fast enough for rapid cleaning, yet slow enough for safe positive handling.

The following models are packaged complete with interchangeable cages to offer you **BIG SAVINGS**. All models are priced with cable lengths as indicated with cages for each cable plus cutter set. Units are equipped with 1/3 H.P. capacitor type motors (1-speed, 115 volt, 60 cycle, reversible) including Air Footswitch-(Model#6237) and Ground Fault Circuit Interrupters for your protection. \*Extra Heavy Duty Motors are available for an additional charge.

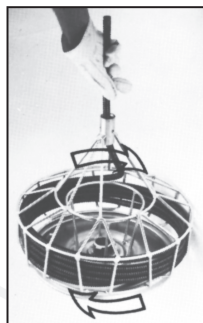

**INSTALL  
CABLE  
CLOCKWISE  
IN CAGE**

**MODEL  
62-A**

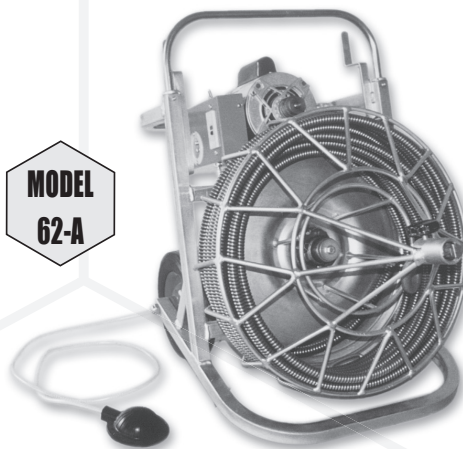

**MODEL  
62-A/B**

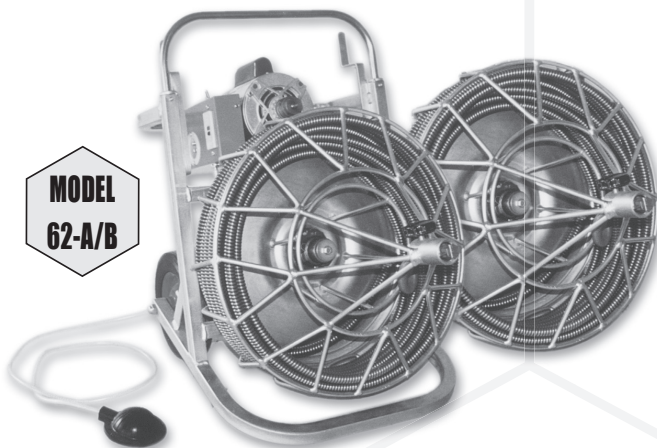

**MODEL  
62-A/B200**

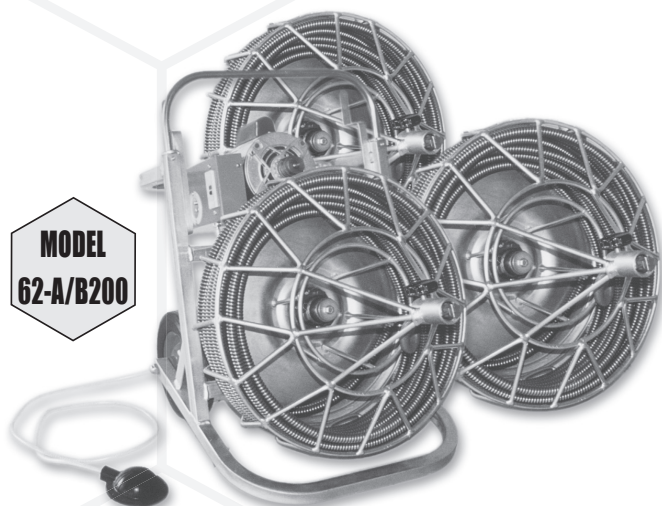

**SEWER CABLE EQUIPMENT COMPANY**  
**FOR PRICING AND INFORMATION PLEASE CALL TOLL-FREE 800.772.7026**

## ILLUSTRATION A - MODEL 62

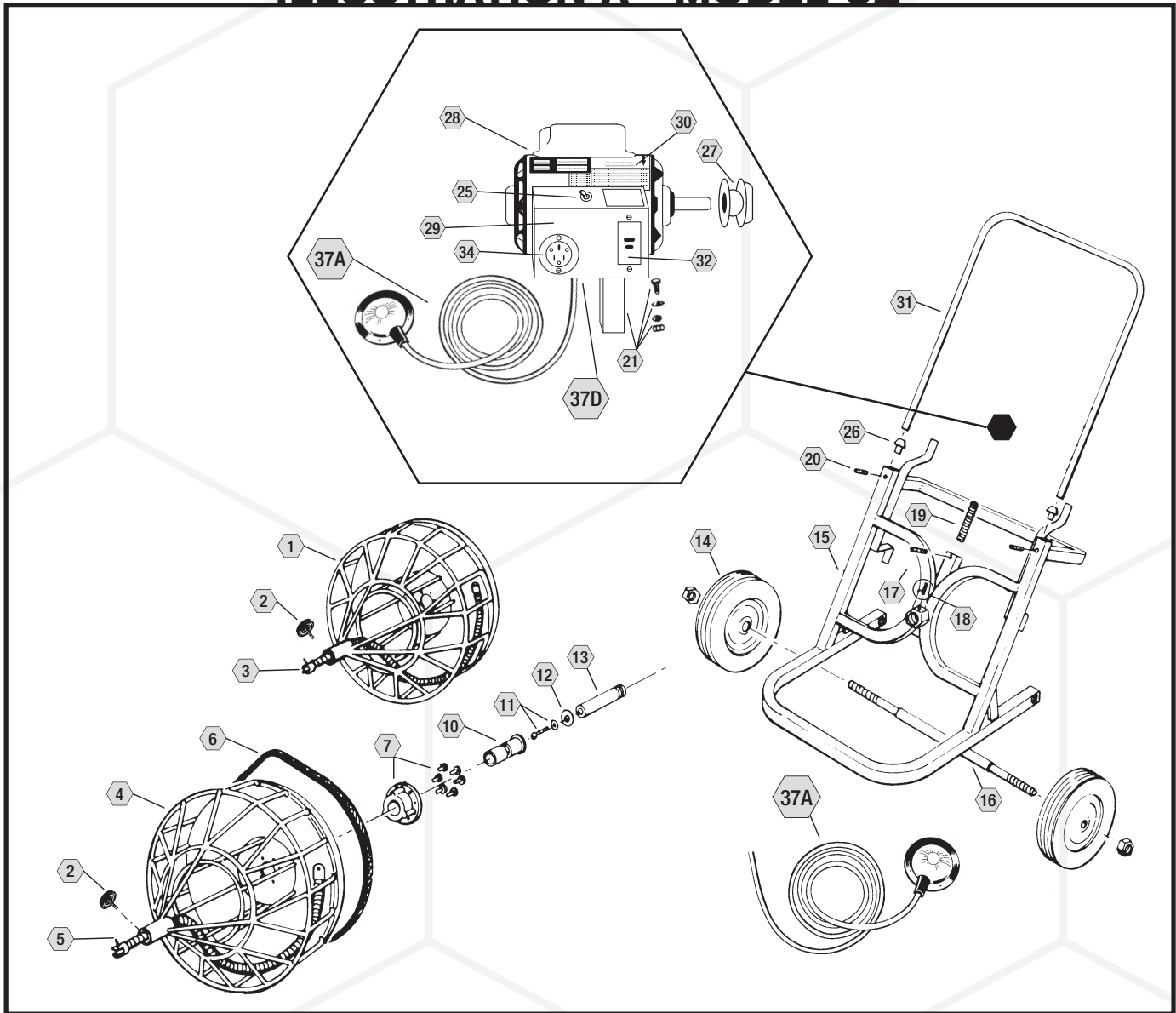

### ILLUSTRATION "A"

KEY #	ITEM #	PART DESCRIPTION
1	6201	CAGE (FOR 1/2" CABLE) WITH HUB ASSEMBLY ONLY
2	6202	CABLE CHUCKING SCREW
3	6203	PIGTAIL FOR 1/2" CABLE
4	6204	CAGE (FOR 3/4" CABLE) WITH HUB ASSEMBLY ONLY
5	6205	PIGTAIL FOR 3/4" CABLE
6	6206	DRIVE BELT 52"
7	6207	BEARING HUB ASSEMBLY
	6208	NEOPRENE CAGE COVER FOR A-CAGE (1/2" CABLE)
	6209	NEOPRENE CAGE COVER FOR B-CAGE (3/4" CABLE)
10	6210	MAIN BEARING
11	6211	RETAINER SCREW LOCK WASHER
12	6212	MAIN BEARING RETAINER
13	6213	SPINDLE
14	6214	WHEELS (PAIR)
15	6215	FRAME
16	6216	AXLE

### ILLUSTRATION "A" - CONT.

KEY #	ITEM #	PART DESCRIPTION
17	6217	MOTOR RETAINER PIN
18	6218	SPINDLE SET SCREW
19	6219	MOTOR SPRING
20	6220	HANDLE LOCK SCREWS (PAIR)
21	6221	MOTOR MOUNT WITH BOLTS, NUTS, WASHERS (SET OF 4)
25	6225	REVERSE SWITCH
26	6226	HANDLE BUSHING (PAIR)
27	6227	1 1/2" PULLEY (MOTOR)
28	6228	CAPACITOR MOTOR (COMPLETE) RIDGID MOUNT
28A	6228A	CAPACITOR MOTOR (COMPLETE) RIDGID MOUNT W/AIR FOOT SWITCH (6237 A & D), INTERNAL G.F.I. (6232), INLET PLUG (6234), REVERSING SWITCH (6225), AND CONDUIT BOX (6229)
28B	6228B	1/2 HP CAPACITOR MOTOR (COMPLETE) RIDGID MOUNT W/AIR FOOT SWITCH (6237 A & D), INTERNAL G.F.I. (6232), INLET PLUG (6234), REVERSING SWITCH (6225), AND CONDUIT BOX (6229)

### ILLUSTRATION "A" - CONT.

KEY #	ITEM #	PART DESCRIPTION
29	6229	CONDUIT BOX ONLY
30	6230	OPERATING INSTRUCTIONS DECAL
31	6231	HANDLE
32	6232	G.F.I. (INTERNAL)
34	6234	FLANGED INLET PLUG 3 PRONG
37A	6237-A	AIR FOOT PEDAL WITH CLEAR RE-INFORCED TUBING
	6237-C	[NOT ILLUSTRATED] - LINEMASTER FOOT SWITCH (REPAIRABLE)
37D	6237-D	AIR SWITCH (INTERNAL)
	6237-E	[NOT ILLUSTRATED] - MICRO SWITCH FOR 6237C



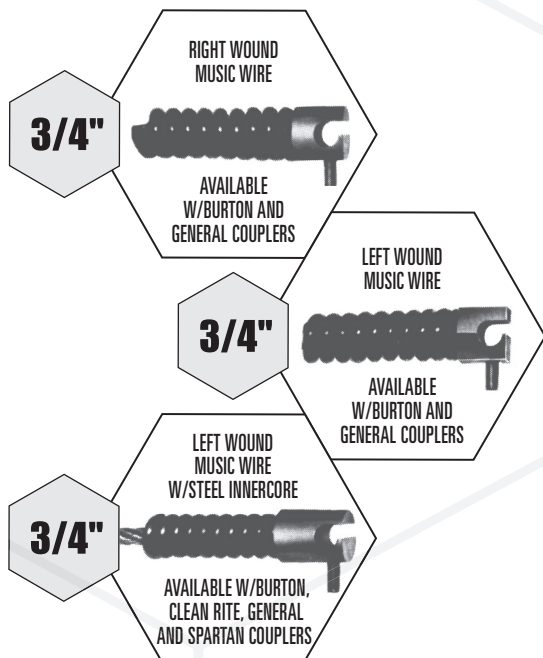
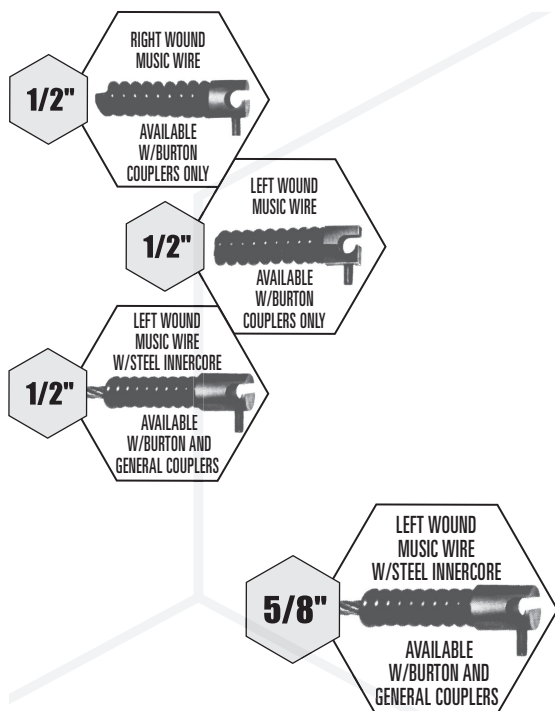

The new RIDGID Kollmann Cable Rust Inhibitor is ideal for helping prevent the premature failure of cables caused by rust. Regular application of Kollmann Cable Rust Inhibitor significantly increase life of drain cleaning cables.

Kollmann Cable Rust Inhibitor outperformed the leading competitive brand in laboratory testing.

**CATALOG # 59982 - 1 QT.**  
**CATALOG # 59987 - 1 GAL. BOTTLE**

**IDENTIFY YOUR CABLES!** Right wound cable Splicers and Couplers are round shouldered fittings. Left wound cable Splicers and Couplers are hex shouldered fittings. All Cutter Heads fit right or left wound cables. **ALL PHOTOS ARE SHOWN WITH BURTON COUPLERS.**

1/2" DIAMETER CABLE		
ITEM NO.	CABLE SIZE	WEIGHT
12.025.LW or .RW	1/2" X 25' LEFT OR RIGHT WOUND	13 LBS.
12.050.LW or .RW	1/2" X 50' LEFT OR RIGHT WOUND	24 LBS.
12.075.LW or .RW	1/2" X 75' LEFT OR RIGHT WOUND	36 LBS.
12.100.LW or .RW	1/2" X 100' LEFT OR RIGHT WOUND	50 LBS.
12.025.LS	1/2" X 25' 49 STRAND STEEL INNERCORE	14 LBS.
12.050.LS	1/2" X 50' 49 STRAND STEEL INNERCORE	28 LBS.
12.075.LS	1/2" X 75' 49 STRAND STEEL INNERCORE	41 LBS.
12.100.LS	1/2" X 100' 49 STRAND STEEL INNERCORE	55 LBS.
5/8" AND 3/4" DIAMETER CABLE		
ITEM NO.	CABLE SIZE	WEIGHT
58.025.LS	5/8" X 25' STRAND STEEL INNERCORE	21 LBS.
58.050.LS	5/8" X 50' STRAND STEEL INNERCORE	42 LBS.
58.075.LS	5/8" X 75' STRAND STEEL INNERCORE	62 LBS.
58.100.LS	5/8" X 100' STRAND STEEL INNERCORE	83 LBS.
34.025.LW or .RW	3/4" X 25' LEFT OR RIGHT WOUND	23 LBS.
34.050.LW or .RW	3/4" X 50' LEFT OR RIGHT WOUND	46 LBS.
34.075.LW or .RW	3/4" X 75' LEFT OR RIGHT WOUND	68 LBS.
34.100.LW or .RW	3/4" X 100' LEFT OR RIGHT WOUND	92 LBS.
34.025.LS	3/4" X 25' STRAND STEEL INNERCORE	26 LBS.
34.050.LS	3/4" X 50' STRAND STEEL INNERCORE	52 LBS.
34.075.LS	3/4" X 75' STRAND STEEL INNERCORE	77 LBS.
34.100.LS	3/4" X 100' STRAND STEEL INNERCORE	103 LBS.

**R = RIGHT • L = LEFT**  
**S = 49 STRAND AIRCRAFT STEEL INNERCORE**



**UGLY GLOVES:** POPULAR PVC GLOVES WITH A ROUGH, TEXTURED FINISH FOR IMPROVED GRIP. FULLY LINED WITH SOFT COTTON JERSEY.  
 SHORT CUFF - PER PAIR  
 LONG CUFF - PER PAIR



**ECONOMY LEATHER PALM GLOVES** WITH DENIM CUFF. HAS EXTRA STRIP OF LEATHER ACROSS PALM FOR REINFORCEMENT - PER PAIR

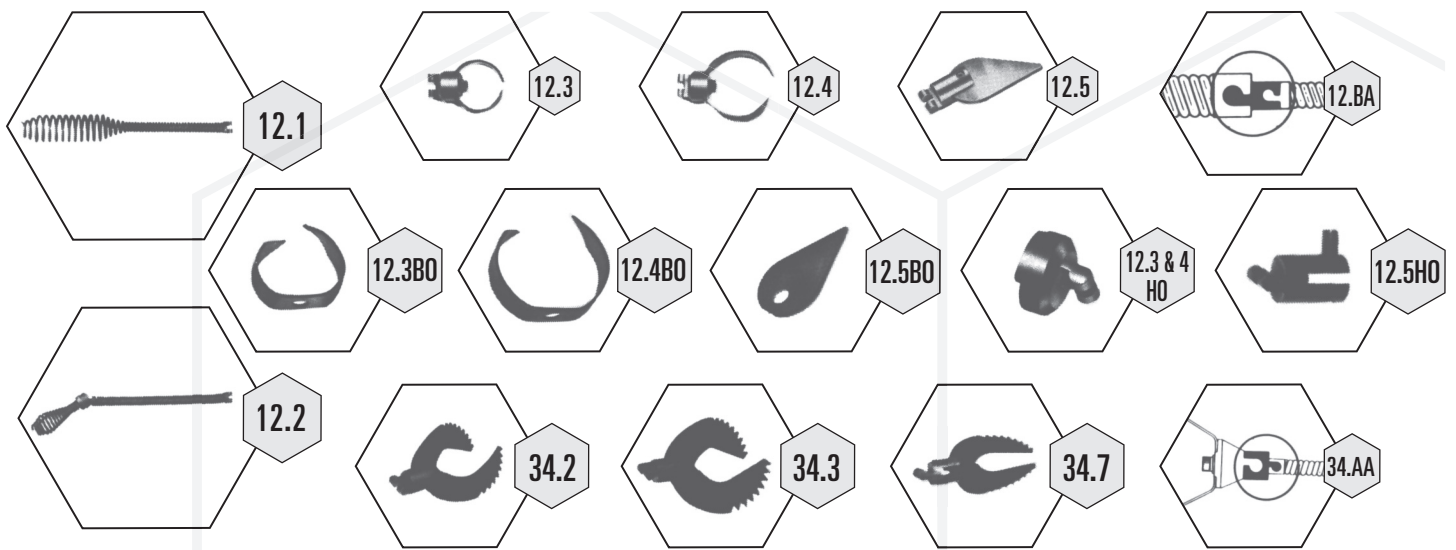

### "SUR LOK" CUTTERS

ITEM NO.	DESCRIPTION
12.1	1/2" FLEXIBLE RETRIEVER
12.2	1/2" DROP HEAD (W/FLEXIBLE LEADWIRE)
12.3	1-1/2" EAGLE CLAW GREASE & SCALE CUTTER
12.4	2" EAGLE CLAW GREASE & SCALE CUTTER
12.5	1-1/2" SPEAR CUTTER
12.BA	CONNECTS 1/2" TO 3/4" CABLE
12.3BO	CUTTER BLADE ONLY
12.4BO	CUTTER BLADE ONLY
12.5BO	SPEAR BLADE ONLY
12.3HO	CUTTER HOLDER ONLY
12.4HO	CUTTER HOLDER ONLY
12.5HO	SPEAR HOLDER ONLY
12.6W	1/2" GREASE WHIP
34.1	RETRIEVER WIRE
34.2	3" SAW CUTTER
34.3	4" SAW CUTTER
34.7	3" ROOT BORE
34.4	2" EAGLE CLAW CUTTER
34.5	3" EAGLE CLAW CUTTER
34.6	4" EAGLE CLAW CUTTER
34.8	6" EAGLE CLAW CUTTER
34.AA	3/4" X 1/2" ADAPTER CONNECTS SEWER LINE CUTTERS TO WASTE LINE CABLE (NOT RECOMMENDED FOR ROOTS)
<b>CUTTERS SETS</b>	
12.CUTSET	CONTAINS: 12.1, 12.2, 12.3, 12.4, 12.5, 12.C1, C2, & C4

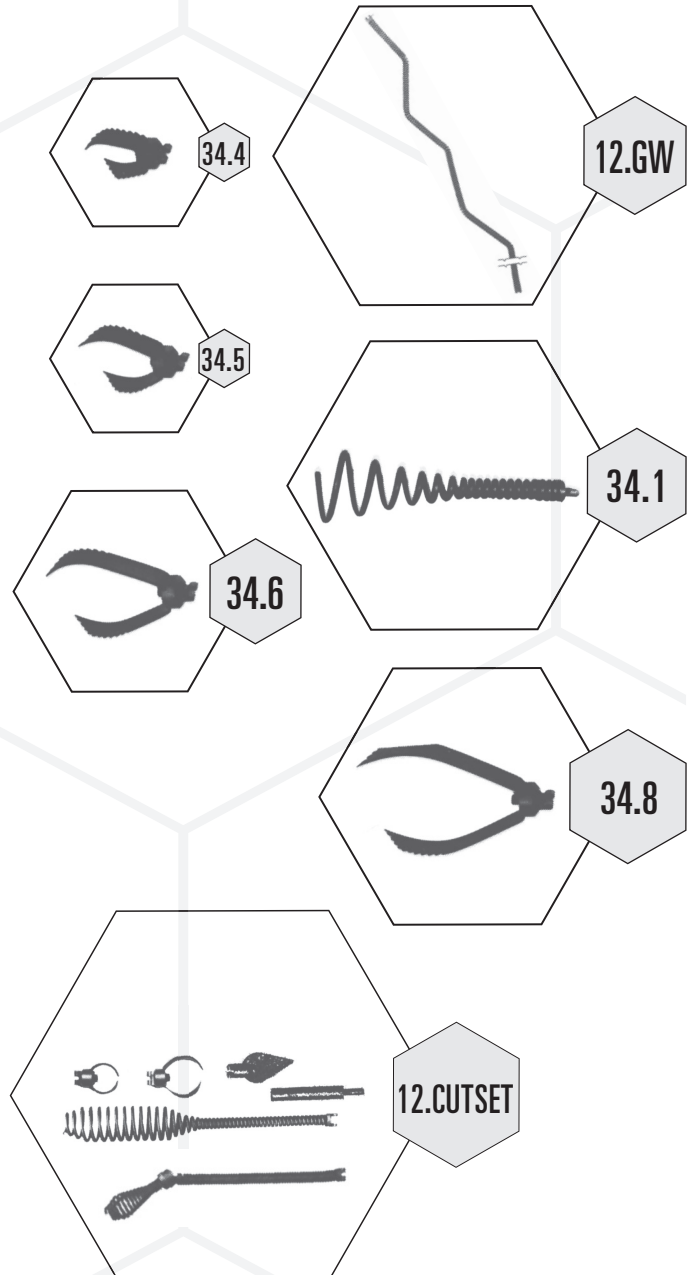



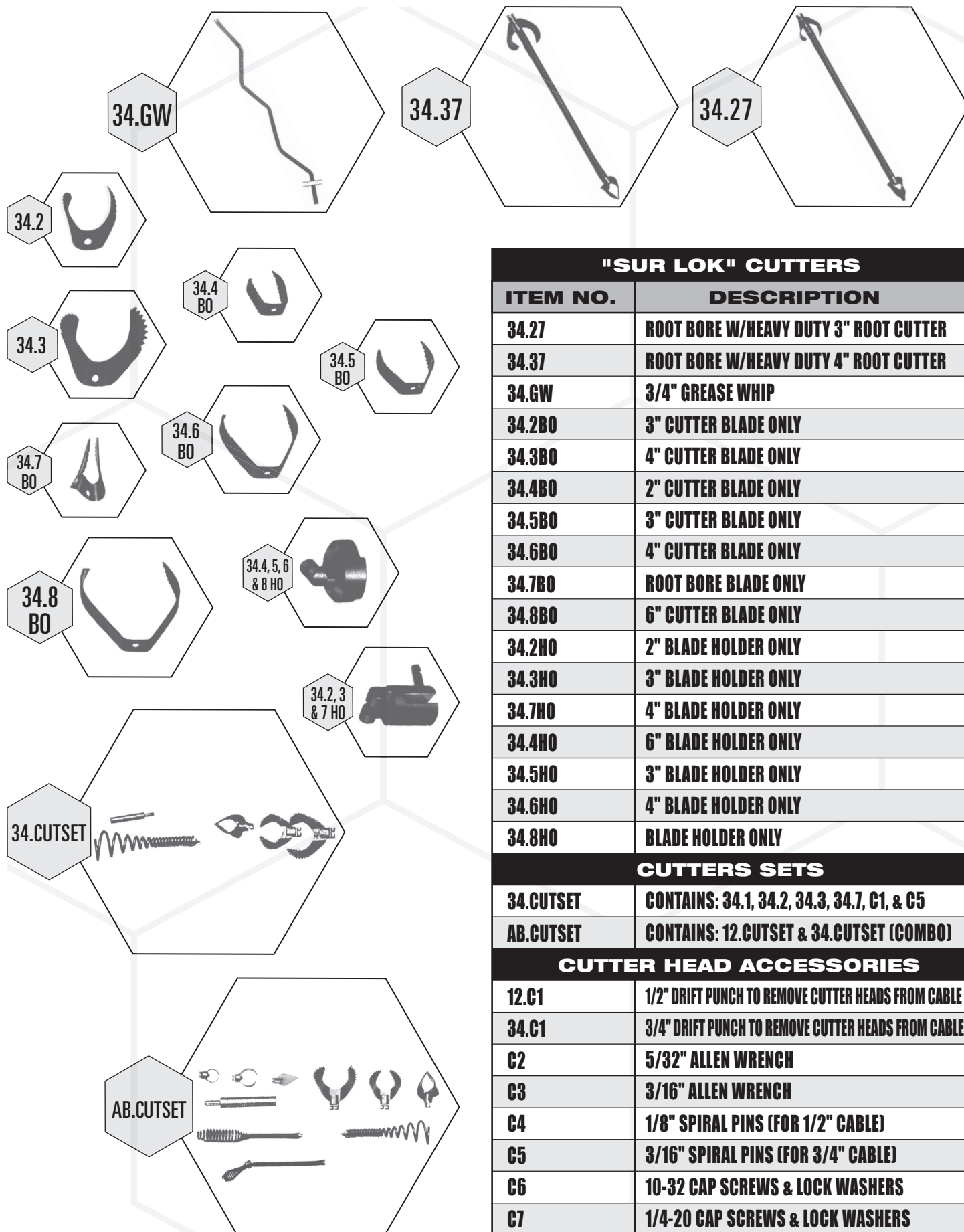

<b>"SUR LOK" CUTTERS</b>	
<b>ITEM NO.</b>	<b>DESCRIPTION</b>
<b>34.27</b>	<b>ROOT BORE W/HEAVY DUTY 3" ROOT CUTTER</b>
<b>34.37</b>	<b>ROOT BORE W/HEAVY DUTY 4" ROOT CUTTER</b>
<b>34.GW</b>	<b>3/4" GREASE WHIP</b>
<b>34.2BO</b>	<b>3" CUTTER BLADE ONLY</b>
<b>34.3BO</b>	<b>4" CUTTER BLADE ONLY</b>
<b>34.4BO</b>	<b>2" CUTTER BLADE ONLY</b>
<b>34.5BO</b>	<b>3" CUTTER BLADE ONLY</b>
<b>34.6BO</b>	<b>4" CUTTER BLADE ONLY</b>
<b>34.7BO</b>	<b>ROOT BORE BLADE ONLY</b>
<b>34.8BO</b>	<b>6" CUTTER BLADE ONLY</b>
<b>34.2HO</b>	<b>2" BLADE HOLDER ONLY</b>
<b>34.3HO</b>	<b>3" BLADE HOLDER ONLY</b>
<b>34.7HO</b>	<b>4" BLADE HOLDER ONLY</b>
<b>34.4HO</b>	<b>6" BLADE HOLDER ONLY</b>
<b>34.5HO</b>	<b>3" BLADE HOLDER ONLY</b>
<b>34.6HO</b>	<b>4" BLADE HOLDER ONLY</b>
<b>34.8HO</b>	<b>BLADE HOLDER ONLY</b>
<b>CUTTERS SETS</b>	
<b>34.CUTSET</b>	<b>CONTAINS: 34.1, 34.2, 34.3, 34.7, C1, &amp; C5</b>
<b>AB.CUTSET</b>	<b>CONTAINS: 12.CUTSET &amp; 34.CUTSET (COMBO)</b>
<b>CUTTER HEAD ACCESSORIES</b>	
<b>12.C1</b>	<b>1/2" DRIFT PUNCH TO REMOVE CUTTER HEADS FROM CABLE</b>
<b>34.C1</b>	<b>3/4" DRIFT PUNCH TO REMOVE CUTTER HEADS FROM CABLE</b>
<b>C2</b>	<b>5/32" ALLEN WRENCH</b>
<b>C3</b>	<b>3/16" ALLEN WRENCH</b>
<b>C4</b>	<b>1/8" SPIRAL PINS (FOR 1/2" CABLE)</b>
<b>C5</b>	<b>3/16" SPIRAL PINS (FOR 3/4" CABLE)</b>
<b>C6</b>	<b>10-32 CAP SCREWS &amp; LOCK WASHERS</b>
<b>C7</b>	<b>1/4-20 CAP SCREWS &amp; LOCK WASHERS</b>

## "SUR LOK" COUPLERS & ADAPTERS

ITEM NO.	DESCRIPTION
12.RS	1/2" SPLICER (MALE & FEMALE COUPLER)
12.RFC	FEMALE COUPLER FOR 1/2" CABLE
12.RMC	MALE COUPLER FOR 1/2" CABLE
12.LS	1/2" SPLICER (MALE & FEMALE COUPLER)
12.LFC	FEMALE COUPLER FOR 1/2" CABLE
12.LMC	MALE COUPLER FOR 1/2" CABLE
12.S	SPLICER FOR 1/2" INNERCORE CABLE (BRAZE ON)
12.FC	FEMALE COUPLER FOR 1/2" INNERCORE CABLE (BRAZE ON)
12.MC	MALE COUPLER FOR 1/2" INNERCORE CABLE (BRAZE ON)
58.S	SPLICER FOR 5/8" INNERCORE CABLE (BRAZE ON)
58.FC	FEMALE COUPLER FOR 5/8" INNERCORE CABLE (BRAZE ON)
58.MC	MALE COUPLER FOR 5/8" INNERCORE CABLE (BRAZE ON)
34.RS	3/4" SPLICER (MALE & FEMALE COUPLER)
34.RFC	FEMALE COUPLER FOR 3/4" CABLE
34.RMC	MALE COUPLER FOR 3/4" CABLE
34.LS	3/4" SPLICER (MALE & FEMALE COUPLER)
34.LFC	FEMALE COUPLER FOR 3/4" CABLE
34.LMC	MALE COUPLER FOR 3/4" CABLE
34.S	SPLICER FOR 3/4" INNERCORE CABLE (BRAZE ON)
34.FC	FEMALE COUPLER FOR 3/4" INNERCORE CABLE (BRAZE ON)
34.MC	MALE COUPLER FOR 3/4" INNERCORE CABLE (BRAZE ON)
58. & 34.GWS	5/8" & 3/4" SPLICER GENERAL CABLE (BRAZE ON)
58. & 34.GWST	5/8" & 3/4" SPLICER (BURTON LEFT WOUND CABLE)
58. & 34.GWSTFC	FEMALE COUPLER FOR 5/8" & 3/4" (BURTON CABLE)
58. & 34.GWSTMC	MALE COUPLER FOR 5/8" & 3/4" (BURTON CABLE)
12.TOGC	CONNECTS 1/2" CUTTERS TO 1/2" GENERAL CABLE
12.BTOGC	BRAZE ON 1/2" CUTTERS TO 1/2" GENERAL CABLE
12.GCT012	ADAPTER FOR 1/2" CABLE TO 1/2" GENERAL CUTTERS
34.TOGC	CONNECTS 3/4" CUTTERS TO 3/4" GENERAL CABLE
34.GCT0GC	ADAPTER FOR 3/4" CABLE TO 3/4" GENERAL CUTTERS

Right wound cable (Flexibility) Splicers and Couplers are round shouldered fittings. Left wound cable (Stiffness) Splicers and Couplers are hex shouldered fittings.

**EXCLUSIVE MONEY SAVING "SUR LOK" COUPLER AND ADAPTER SYSTEM!** For permanent repair of broken or kinked cables. **SAVES PRICE OF A NEW CABLE...**

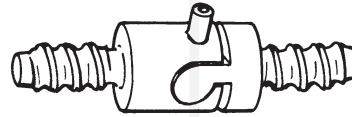

12.RS, 34.RS



12.RFC, 34.RFC

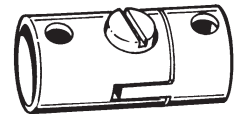

58.GWS, 34.GWS



12.RMC, 34.RMC

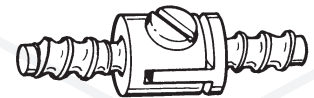

58.GWST, 34.GWST

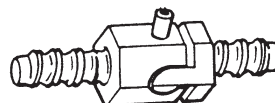

12.LS, 34.LS



12.TOGC

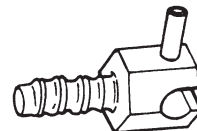

12.LFC, 34.LFC



12.BTOGC



12.LMC, 34.LMC



12.GCT012



12.S, 58.S, 34.S



12.FC, 58.FC, 34.FC

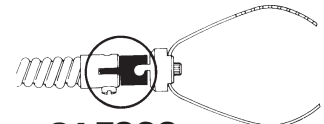

34.TOGC



12.MC, 58.MC, 34.MC

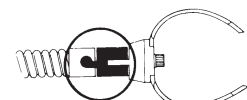

34.GCT034



(ABOVE HEADS AVAILABLE FOR 3/8" STEEL INNERCORE CABLES)

**STEEL INNERCORE CABLE  
W/DROPHEAD ATTACHMENT**

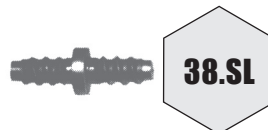
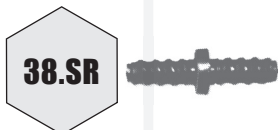
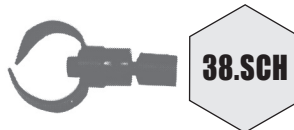
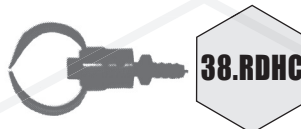
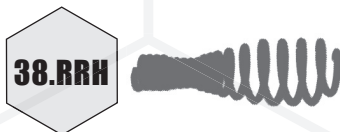

3/8" DIAMETER CABLE		
ITEM NO.	CABLE SIZE	WEIGHT
38.25.LW or .RW	3/8" X 25' LEFT OR RIGHT WOUND	7 LBS.
38.35.LW or .RW	3/8" X 35' LEFT OR RIGHT WOUND	9 LBS.
38.50.LW or .RW	3/8" X 50' LEFT OR RIGHT WOUND	13 LBS.
38.25.LS	3/8" X 25' 49 STRAND STEEL	9 LBS.
38.35.LS	3/8" X 35' 49 STRAND STEEL	12 LBS.
38.50.LS	3/8" X 50' 49 STRAND STEEL	17 LBS.
38.75.LS	3/8" X 75' 49 STRAND STEEL	26 LBS.
38.100.LS	3/8" X 100' 49 STRAND STEEL	35 LBS.
3/8" CABLE REPLACEMENT HEADS		
ITEM NO.	DESCRIPTION	
38.LRH or .RRH	3/8" RETRIEVER HEAD LEFT OR RIGHT WOUND	
38.LDH or .RDH	3/8" DROPHEAD LEFT OR RIGHT WOUND	
38.LDHC or .RDHC	3/8" DROPHEAD CUTTER LEFT OR RIGHT WOUND	
38.SDH	3/8" DROPHEAD RETRIEVER	
38.SCH	3/8" DROPHEAD CUTTER	
38.SL or .SR	3/8" SPLICER FOR LEFT OR RIGHT WOUND CABLE	

R = RIGHT HAND WOUND

L = LEFT HAND WOUND

S = 49 STRAND AIRCRAFT STEEL INNERCORE

RH = RETRIEVER HEAD

DH = DROPHEAD

DHC = DROPHEAD CUTTER

**SEWER CABLE EQUIPMENT COMPANY**

FOR PRICING AND INFORMATION PLEASE CALL TOLL-FREE 800.772.7026



**13.RW WITH 13.RRH**



**13.LW WITH 13.LRH**



**13.LS WITH 13.LRH**



**13.RRH**



**13.LRH**



**13.RDH**



**13.LDH**



**13.SDH**



**UGLY GLOVES:** POPULAR PVC GLOVES WITH A ROUGH, TEXTURED FINISH FOR IMPROVED GRIP. FULLY LINED WITH SOFT COTTON JERSEY.  
SHORT CUFF - PER PAIR  
LONG CUFF - PER PAIR



**ECONOMY LEATHER PALM GLOVES** WITH DENIM CUFF. HAS EXTRA STRIP OF LEATHER ACROSS PALM FOR REINFORCEMENT - PER PAIR



5/16" DIAMETER CABLE		
ITEM NO.	CABLE SIZE	WEIGHT
13.015.LW or .RW	5/16" X 15' LEFT OR RIGHT WOUND	4 LBS.
13.025.LW or .RW	5/16" X 25' LEFT OR RIGHT WOUND	6 LBS.
13.035.LW or .RW	5/16" X 35' LEFT OR RIGHT WOUND	9 LBS.
13.015.LS	5/16" X 15'	4 LBS.
13.025.LS	5/16" X 25'	6 LBS.
13.035.LS	5/16" X 35'	9 LBS.
13.050.LS	5/16" X 50'	12 LBS.
5/16" CABLE REPLACEMENT HEADS		
ITEM NO.	DESCRIPTION	
13.LRH or .RRH	5/16" RETRIEVER HEAD LEFT OR RIGHT WOUND	
13.LDH or .RDH	5/16" DROPHEAD LEFT OR RIGHT WOUND	
13.SDH	5/16" DROPHEAD LEFT WOUND FOR STEEL	

**R = RIGHT HAND WOUND**

**L = LEFT HAND WOUND**

**S = 49 STRAND AIRCRAFT STEEL INNERCORE**

**RH = RETRIEVER HEAD**

**DH = DROPHEAD**



The new RIDGID Kollmann Cable Rust Inhibitor is ideal for helping prevent the premature failure of cables caused by rust. Regular application of Kollmann Cable Rust Inhibitor significantly increase life of drain cleaning cables.

Kollmann Cable Rust Inhibitor outperformed the leading competitive brand in laboratory testing.

**CATALOG# 59982 - 1 QT.**

**CATALOG# 59987 - 1 GAL. BOTTLE**

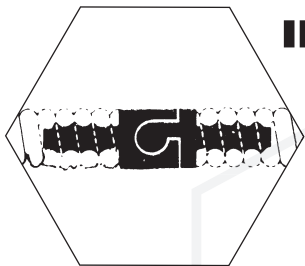

# "SUR LOK" COUPLER SYSTEM CABLE REPAIR INSTRUCTIONS

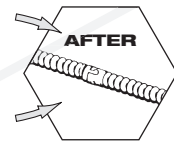
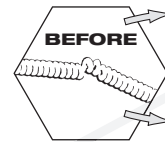

IF A KINK HAS BADLY DISTORTED CABLE COILS, TO REPAIR DAMAGE, SECTION SHOULD BE CUT OUT AND SPLICED WITH AN EXCLUSIVE "SUR LOK" SPLICER SHOWN IN THESE SIMPLE "SUR LOK" CABLE REPAIR INSTRUCTIONS. "SUR LOK" COUPLERS CAN SAVE YOU CABLE REPLACEMENTS...

## STEP 1

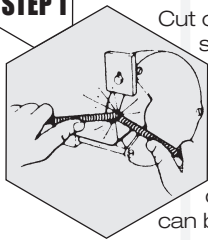

Cut out damaged section of cable by using edge of grinding wheel as shown. A high speed hack saw blade or a heavy duty bolt cutter can be used.

## STEP 2

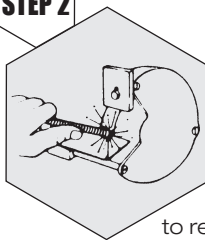

Grind flat both cut ends of cable to be spliced. Dress ends of cable to remove burrs.

## STEP 3

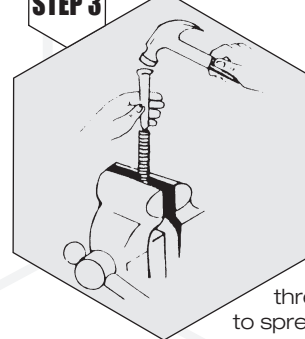

Clamp cable in vise as shown with end extended approximately 1 1/2" above vise jaw. Insert tapered punch into cable and hit with hammer two or three good sharp blows, to spread top coil.

## STEP 4

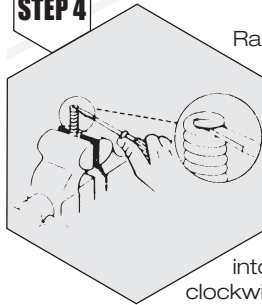

Raise first tapered coil with sharp edged tool to enable first thread of coupler to thread into cable.

**NOTE:** If your cables are L.H. wound, you must thread coupler into cable in a counter-clockwise direction.

## STEP 5

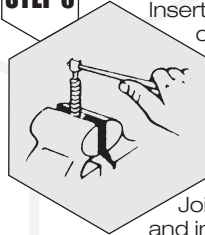

Insert male coupler in end of coil. Secure a crescent wrench to head and screw into coil until bottomed. On other piece of cable to be spliced repeat above instructions. To screw female part into coil use a drift punch inserted through opening in coupler.

**CAUTION: DO NOT OVERTIGHTEN, AS THIS MAY CAUSE CABLE TO RUPTURE.**

Join two pieces of cable male and female part and install drive pin.

## BRAZING INSTRUCTIONS FOR STEEL INNERCORE CABLE:

Before brazing new coupler to end of cable, it is important the cable be prepared by grinding the end flat and removing any grease, oil or rust. Secure cable in vise then select the appropriate coupler to be installed. Make sure the coupler sits square on end of cable. Coupler must be brazed on, **"DO NOT WELD"**. Set **Oxygen-Acetylene Gauges to: 20 P.S.I. Oxygen and 5 P.S.I. Acetylene.**

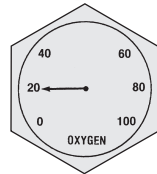

For 1/2" diameter cable use 3/32" flux loaded brass rod. For 5/8" or 3/4" diameter cable use 1/8" flux loaded brass rod. When brazing, adjust to a blue-white flame. Note: holes are on both sides of coupler for the purpose of brazing. Apply heat to one side of coupler till it reaches an orange color (not bright red)\*. Fill hole with flux loaded brass. Repeat this procedure on opposite side of coupler. Allow to cool before removal from vise. \*Note: too much heat will cause damage to cable.

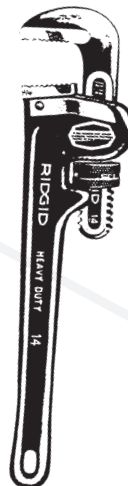

## STRAIGHT PIPE WRENCHES

Sturdy, cast-iron housing and I-beam handle with full floating hook jaw, nonstick adjustment nut and replaceable hook and heel jaws.

CAT. NO.	MODEL NO.	SIZE IN.	SIZE MM	PIPE IN.	PIPE MM	WT.
31015	12	12	300	2	50	2.75lbs
31020	14	14	350	2	50	3.5lbs
31025	18	18	450	2 1/2	54	5.75lbs

## TAPERED PUNCH

See Figure 3 of Cable Repair Instructions



## SUR LOK COUPLER INSTALLATION TOOL

See Figure 5 of Cable Repair Instructions



## METER KEY

- Combination Meter Key
- Gas Cock Wrench
- Slotted or Square Flush Plug Tool

## SEWER CABLE EQUIPMENT COMPANY

FOR PRICING AND INFORMATION PLEASE CALL TOLL-FREE 800.772.7026



### LIMITED WARRANTY...

All cables manufactured by **SEWER CABLE EQUIPMENT CO.** carry a one year limited warranty against defects. Should any cable break during this period, we ask that you provide proof of purchase and nature of failure. **SEWER CABLE EQUIPMENT CO.** will repair or replace at our option any cables found to be defective. Transportation of the cable is the responsibility of the user.

No adjustment can be made on kinked cables, since a kink is evidence of abuse and results from the use of too much pressure or used in too large a sewer drain line.

No adjustment can be made where there is greater wear at a break than noticeable on the balance of the cable.

To submit your claim under the conditions of this warranty, contact **SEWER CABLE EQUIPMENT CO.** by telephone, facsimile or U.S. Mail. **SEWER CABLE CO.** will advise you if the cable in question should be returned to the factory.

This warranty is made in place of all other warranties, express, statutory or implied, including those of merchantability and of fitness for purpose.

### TERMS & FREIGHT ALLOWANCE...

Terms are net 30 days on Approved Credit. Minimum billing is \$35.00. MasterCard®, and VISA® Credit Cards Accepted. Orders shipped United Parcel Service (UPS) will be prepaid and billed on approved credit.

\* PRODUCTS & EQUIPMENT CONTAINED WITHIN THIS CATALOG MAY VARY. PLEASE CHECK WITH SEWER CABLE EQUIPMENT CO. REGARDING AVAILABILITY.

### SPECIAL NOTES...

Kinked cables are conclusive evidence of abuse and/or misuse. A Coiled Cable cannot be forced, nor can a long length of cable be pushed ahead of the rotating machine without running the risk of kinking. In the event of a kinked cable, cut out the damaged section and splice for continued service.

If proper cable size is used and equipment is operated as close as possible to pipe outlets, while held securely, kinkage of cable will not occur. Always penetrate line slowly, never force cable as action at end of cable disperses blockage not cable pressure.

**ACIDS:** Drano®, Liquid Plumber® and other "easy chemical remedies" leave acid residue in the drain. No matter how diluted, acid solutions cause crystallization of steel cables which can easily be identified. If at all possible the drain should be flushed before cleaning. Obviously this cannot be done in many cases. Where flushing is impossible, wash cable with garden hose as soon as stoppage has been cleared.



# **SEWER CABLE EQUIPMENT COMPANY**

**2834 MARCO STREET**

**LAS VEGAS • NEVADA, 89115**

**702.433.5401 • FAX 702.433.5403**

**TOLL-FREE 800.772.7026**

**EMAIL: SEWCAB@GMAIL.COM**

**WEBSITE: WWW.SEWERCABLEEQUIP.COM**

## **EQUIPMENT, CABLES, PARTS & REPAIRS**

### ***DON'T FORGET... WE SELL:***

- **Machines by Burton Pattern, Ridgid, Gorlitz, & General**
- **Hydrojetters by General, Ridgid & Gorlitz**
- **Camera Equipment by Ridgid/Seesnake & General**
- **Line Locating Equipment by Ridgid & General**
- **PVC ugly gloves, Double Palm Leather Gloves & Staple Palm Leather Mitts**
- **Toilet Augers by Burton Pattern, General, & Ridgid**
- **Ridgid Cable Rust Inhibitor & Snake Oil by General**
- **Cables for Burton Pattern, Gorlitz, Ridgid, General, & Most Other Manufacturers**
- **Cable Blades, Holders, Ends, Connectors & Splicers**
- **Repairs on Most All Machines**

***CALL TODAY TO SCHEDULE A DEMONSTRATION  
OR TO RECEIVE A FREE CATALOG & PRICE LIST!***

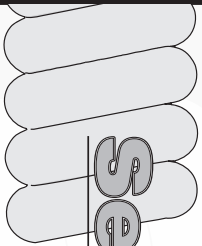

# Sewer Cable

Equipment Company

2834 MARCO STREET  
LAS VEGAS, NEVADA 89115